

All information contained within this Consumer Electronics/Bluetooth & Audio Technology Quick Reference Guide was accurate at the time of publication. We reserve the right to change features, operation and/or functionality of any vehicle specification at any time without incurring any obligation to make the same or similar changes to products previously sold. Your Subaru dealer is the best source for the most current information. For detailed operating and safety information, please consult your Owner's Manual.



MSA5B1420A
Printed in USA 07/13



2014

**BRZ, Forester, Impreza, WRX,
WRX STI, XV Crosstrek**

Consumer Electronics/Bluetooth®



Quick Reference Guide



Bluetooth Basics

- The hands-free system may not operate properly under the following conditions:
 - o The cell phone is turned off.
 - o The cell phone is not connected to the hands-free system.
 - o The cell phone is not in the phone call area.
 - o The battery of the cell phone has run down.
 - o The cell phone is behind the seat or in the glove box.
 - o A metal material covers or touches the cell phone.
- Depending on the type of cell phone that is used, the screen on the cell phone may remain illuminated while the ignition switch is in the “ON” position. If this occurs, consult your cell phone manual to adjust the cell phone settings.
- Depending on the setting of the cell phone, the dial lock function may be activated after making a call. Deactivate the automatic dial lock function of the cell phone before using the hands-free system. Do not perform this operation while driving.
- Depending on the type of cell phone that is used, operation and sound volume may vary.
- Depending on the type of cell phone that is used, not all phone functions may be compatible with your vehicle.
- When the ignition switch is turned to the “LOCK/OFF” position during a call, the call may be disconnected or continued on the cell phone, depending on the type of cell phone that is used. Note that operation of the cell phone may be necessary if the call is continued on the cell phone.

- Do not speak at the same time as the other party during a call. If you and the other party speak at the same time, it may be difficult for the other party to hear your voice and vice versa. This is normal.
- The receiver sound volume should be set as low as possible. Otherwise, the party you are calling may notice an undesirable echo sound.
- Speak clearly and loudly.
- Your voice may be difficult to be heard by the receiving party under the following conditions:
 - o Driving on a rough road.
 - o Driving at a high speed.
 - o Driving with a window open.
 - o When air from the ventilator blows directly toward the microphone.
 - o When the sound coming from the ventilator is loud.
 - o When the cell phone is positioned too closely to the microphone.
- The sound quality may degrade due to the influence of the cell phone that is connected to the system or the circumstances of the Bluetooth network.
- When another Bluetooth device is simultaneously connected, noise may be heard in the voice coming from the hands-free phone.

Bluetooth for AM/FM Stereo with Single Disc CD Player and AM/FM Stereo HD Radio® with Single Disc CD Player

These buttons will be used in the instructions and images that follow.



Press the **TALK BUTTON** and follow the phone prompts. You may need to set the language before pairing your phone.

Pairing Your Cell Phone

Press the **PHONE OFF HOOK BUTTON** and listen to phone prompts.



Press the **TALK BUTTON** and name your phone.



Press the **TALK BUTTON** and say “Confirm.”



Pass-key for pairing will be given audibly as well as be displayed on the radio.



Put your phone into Bluetooth pairing mode and pair your phone to the system using the pass-key provided. When phone is successfully paired you will hear “The phone is paired and ready for use.”



Making a Call

Press **PHONE OFF HOOK BUTTON**. Press the **TALK BUTTON**, then say “Dial by number.”



Press the **TALK BUTTON** again and say the number.



Press the **PHONE OFF HOOK BUTTON** to dial or press the **TALK BUTTON** to add more numbers. The phone will start dialing.



To end the call, press the **PHONE ON HOOK BUTTON**.

Receiving a Call

When a call comes in you will be notified. If the audio system is on, the audio system will mute and a voice prompt will inform you. Press the **PHONE OFF HOOK BUTTON** to accept the call.



- If you want to put the call on hold, press the **PHONE ON HOOK BUTTON**.
- If you want to decline the incoming call, press and hold the **PHONE ON HOOK BUTTON**.
- If you want to adjust the volume of the call, use the **PLUS** or **MINUS SWITCH** on the steering wheel.

Bluetooth for AM/FM Stereo HD Radio® with Single Disc CD Player and Navigation System



AUDIO BUTTON

Pairing Your Cell Phone

Press the **AUDIO BUTTON**; touch the up and down arrows at the top or bottom of the column on the display, until the “Info” soft key appears. Then touch the “Info” soft key.

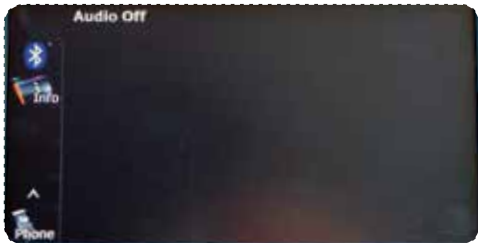

Then touch “Bluetooth.”



Now touch “Connect Phone.”



Touch “Add New.”



A pass-key pairing number will appear on the screen. Put your phone into Bluetooth pairing, search or discoverable mode. Depending on the phone's make, model and software; the phone may connect automatically or the pass-key number may need to be inputted on the phone. Pair your phone to the system.



When the phone is successfully paired, the screen will show the phone's name on the list.



Making a Call

NOTE: This system is designed primarily for voice command operation. However, manual input is also recognized. For voice command operation, please consult the Navigation Owner Manual. For manual input, follow the steps below.

Press the **AUDIO BUTTON**; then touch the “Phone” soft key. A numeric keypad will be displayed.



Touch the numbers for the phone number you wish to call. When complete, touch the green “Phone” soft key to make the call.



During a Call

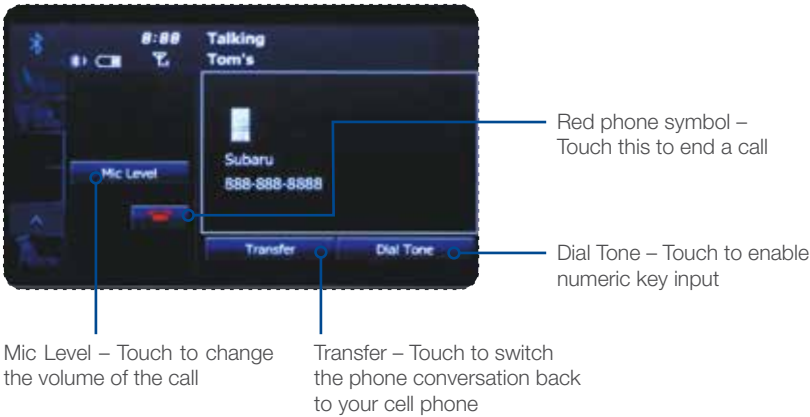

Receiving a Call

